

236

LOCK CLASS "A"

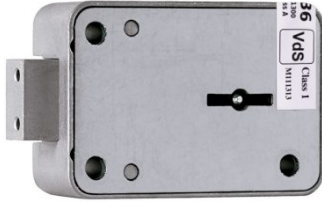

Certified lock according to standard EN 1300, class A with 11mm of movement of the lever. It is a changeable code key lock which allows the lock to be adapted to a new key code by means of a simple manoeuvre.



- AGA supplies as standard the lock without key.
- Zinc plated and tempered steel covered.
- Prepared for cable mounting which is joined to the vault bolt (256, 257).
- Different key lengths supplied on request.
- Lock with key guide (2900) available fixed in the cover plate.
- Assembly with chip operated by the lever, without disassembling the lock.

TYPE OF LOCK

MECHANICAL

LOCK SYSTEM

BLOCKING

N° OF COMBINATIONS

190.000

POSSIBILITY OF MASTERKEY

NO

FINISH

ZINC PLATED

WEIGHT (grs.)

630

CERTIFICATES

VdS (Germany)

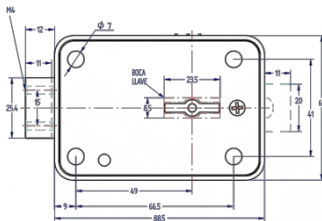

INSTALLATION POSITIONS

